



SLIMLINE DVD PLAYER

User Guide



DIVX \ MPEG4 \ DVD \ SVCD \ VCD \ CD \ MP3 PLAYER



Now you have purchased a Tevion® product you can rest assured in the knowledge that as well as your 3 year parts and labour warranty you have the added peace of mind of dedicated helplines and web support

AFTER SALES SUPPORT

UK/N.IRELAND HELPLINE NO 01270 508538

REP. IRELAND HELPLINE NO 1800 995 036

WEB SUPPORT www.qesh.co.uk

MODEL NUMBER: 44330

Chapter

- 02. Welcome Section
- 03. General Information and Safety Instructions
- 04. Battery Handling and Usage
- 05. Accessories
- 06. Features
- 07. Remote Control Operation
- 08. Connecting Your DVD Player
- 09. DVD Operation
- 10. USB Operation
- 11. Setup Menu
- 12. Troubleshooting
- 13. Technical Specifications
- 14. Warranty Card
- 15. Fault Report Card

Congratulations on choosing to buy a Tevion® product. By doing so you now have the assurance and peace of mind that comes with purchasing a product made by one of Europe's leading manufacturers.

All products brought to you by Tevion® are manufactured to the highest standards of performance and safety, and, as part of our philosophy of customer service and satisfaction, are backed by our comprehensive 3 year warranty.

We hope you enjoy using your purchase for many years to come.

General Information and Safety Instructions 3

Please read through the following safety information before use



The lightning flash and arrowhead within the triangle is a warning sign alerting you of dangerous voltage inside the product



The exclamation mark within the triangle is a warning sign alerting you of important safety instructions concerning the product

CAUTION
RISK OF ELECTRIC SHOCK
DO NOT OPEN

- To avoid risk of electric shock do not attempt to open this appliance.
- Keep away from fire.
- Do not expose the appliance to water, rain or dampness.
- Keep this appliance away from direct sunlight and other heat sources.
- Keep this appliance away from strong magnets.
- Never cover the ventilation slots on the underside or back of the appliance.
- Avoid placing heavy objects on top of the appliance.
- Always disconnect the appliance from mains power before cleaning.
- Clean the exterior of the appliance with a soft cloth only.

Remote Control

The remote control uses 2 x AAA batteries.

When inserting batteries always ensure the correct +/- polarity.

Battery Safety

Never throw batteries into fire or expose to excessive heat sources.

If batteries are swallowed, please seek immediate medical attention

Ensure correct polarity when installing batteries

Do not recharge non-rechargeable batteries

Disposal of Your Old Product

Electric and electronic equipment (EEE) contains materials, parts and substances which can be dangerous to the environment and harmful to human health. Once this appliance has reached the end of its life span, the unit in its entirety should be taken to a recycling centre. Please contact your local authority for details of recycling schemes in your area.



Do not dispose of batteries in your household waste. Please contact your local authority for details on safe disposal.



Do not dispose of this product in your household waste. Please contact your local authority for details of recycling schemes in your area.

The following accessories are included with your slimline DVD player. Should any of these be missing, please contact the customer support team on the number below.



1 X Remote control



1 X Scart Cable



1 X AV Cable

- DVD Freeze frame function.
- Random track playback.
- Audio out connection.
- USB Function
- RGB Connection

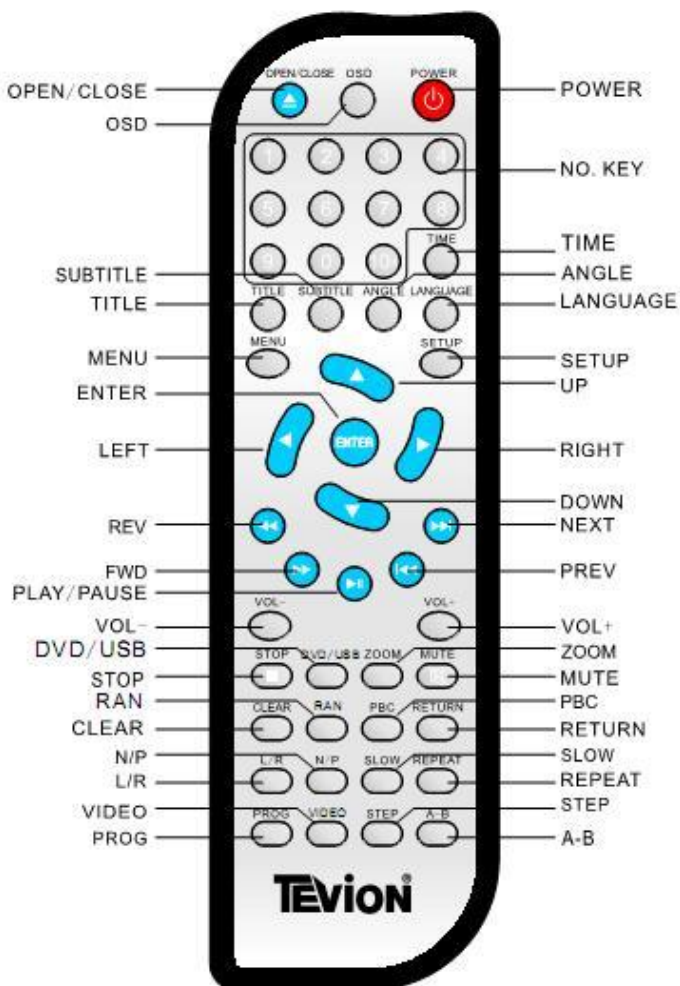

Remote Control Functions

The remote control requires 2 x AAA batteries (supplied). Slide off the back cover and insert batteries ensuring the correct +/- polarity. Slide the cover back on until it clicks into place. Always ensure to point the remote control directly at the infra-red sensor on the front of the DVD player.

Battery Installation

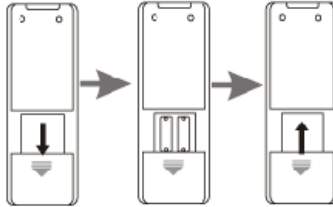

Remote Control Operating Conditions

1. Aim remote control at remote sensor of DVD.
2. Do not drop the unit from a high position or cause high impacts.
3. Do not place the remote control in hot or moist environments.
4. Do not splash water or any other liquid on remote control.
5. The remote control works best within 7metres from the DVD player.
6. Do not expose the remote control sensor directly to a heat source or it will malfunction.



Front Panel

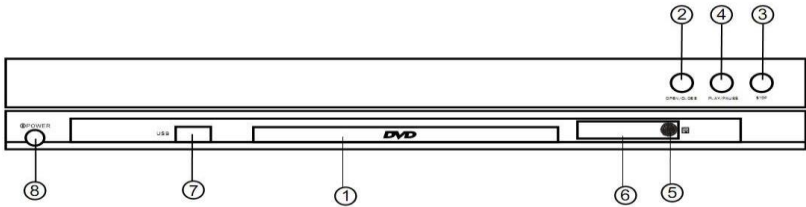

- | | |
|----------------------|----------------------------|
| 1. DVD Door | 5. Remote Control Receiver |
| 2. Open/Close Button | 6. Display Window |
| 3. Stop Button | 7. USB Input Slot |
| 4. Play/Pause button | 8. Power Button |

Rear Panel

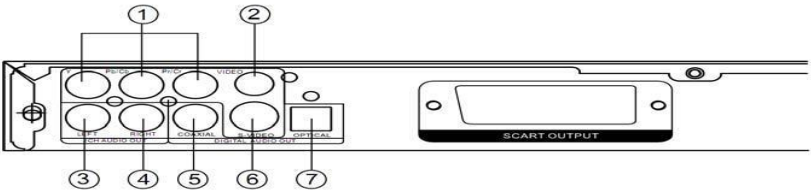

1. Y Pb/Cb Pr/Cr component output jack
2. Video Output Jack
3. 2 CH Left Output Jack
4. 2 CH Right Output Jack
5. Digital Signal Coaxial Out Jack
6. S-Video Output Jack
7. Digital Signal Optical Output Jack

Connecting Your DVD Player

This product has a choice of three connections but these cannot be connected at the same time.

The choice of connection will depend on the video jack on your TV,

- In order to connect your DVD to your TV simply use the scart lead provided to connect from the scart socket on the DVD to the scart socket on your TV itself. Then connect the power supply to a mains socket.
- Also via the AV Output socket from the DVD player using the AV cable provided (red, yellow and white) to the AV Input on your TV
- Also via the RGB socket (red, green and blue) from the DVD player to the RGB socket on your TV

Connecting to a HIFI System

If you also want to have your HIFI System connected to the DVD player you can connect via the audio output socket on the DVD using a RCA cable (red on the right, white on the left) but you must have Audio In on the HIFI System. You can also connect via an amplifier if you do not have Audio In on your HIFI System.

After completing the connection of your appliance you can now switch the power to on and press the power button on the front of the unit. When you switch on your DVD your TV may automatically divert to the DVD mode and will display the Tevion logo on your TV screen (this is not the case for all appliances.) If this does not display then you may need to change your TV into the input mode you chose example scart, AV or RGB (refer to your TV user manual on how to do this.)

You will also need to press the 'Video' button on your remote to select the input mode of the DVD

- S-Video, choose S-video mode
- (Y.Cb,Cr) choose YUV mode
- Scart choose RGB mode

If you have an audio system connected you will need to choose the correct audio output on the amplifier (refer to your amplifier manual on how to do this.)

Disc Loading

Do not play any cracked broken or deformed disc. The disc is rotated at high speed, so it is very dangerous to play any broken or deformed disc and this may cause damage to the player.





Step 1: Press the 'open/close' button, the disc tray will slide out automatically
Step 2: Load a disc into the tray and press 'open/close' the screen will indicate loading and the player will identify the format of the disc, and then indicate it on the upper left of the TV screen

- After reading the disc it will go to the menu of the DVD or title menu
- When playing CD discs it will play in the sequence chapter number

Operation

During disc playback to pause the DVD press the 'play/pause' button and press this again to resume normal play Press the 'stop' button once to stop your DVD and press 'play/pause' to resume. Press the stop button for the second time to stop the DVD completely.

Press 'previous' button, the previous chapter will be played

Press 'next' button, the next chapter will be played

By pressing the 'forward' or 'rewind' button continuously you can change the speed of skipping x2, x4, x8, x16, x32.

You can select a desired subtitle from the available ones encoded on the disc, this operation is only available with supported DVDs press the 'subtitle' button continuously to change between languages.

Some DVDs also have the angle feature so you can view the film from another angle, if your DVD supports this option press the 'angle' button to change viewing angle.

During DVD playback press the 'title' button to return to the DVD root menu use the direction buttons to navigate through the menu, in the chapter selection menu you can use the numeric buttons to select the desired chapter.



With CD playback press the numeric buttons to select the track or use the direction buttons to navigate to the chosen track.

When using VCD discs press the PBC button to return to root menu.

Press the 'N/P' button to select either format NTSC or PAL, this will depend on the colour format of your TV.

Press the 'slow' button during DVD playback to view your disc in slow motion press this continuously to change speed 1/2, 1/4, 1/8, 1/16.

Press the 'step' button to freeze the frame and continuously press this to move from frame to frame. Press the 'play/pause' button to resume normal play

You can zoom in on your DVD by pressing the 'zoom' button the zoom size will display on screen until you resume normal size playback press this continuously to increase the zoom x2, x3, x4.

The USB reader only performs MP3 and JPEG picture playback. The maximum capacity the USB will accept is 4GB.

Power on your DVD player ensuring no disc is inserted in the tray, now insert the USB device and press the 'DVD/USB' button. Use the direction keys to navigate to the USB option, press 'enter' to select this and a waiting message will appear on your TV screen then press 'enter' again to confirm USB. Your files will then display on the screen, you can select your desired file using the direction keys to navigate to this and 'enter' button to confirm this.



Please note if using a MP3 CD you can access your files as shown above.

With USB and MP3 music selection you have the option for repeat press the 'repeat' button to select from single song play, single song repeat, folder repeat or folder play. Press 'repeat' continuously and your choice will display on the bottom of your screen.

JPEG Picture Operation

When viewing JPEG pictures your screen will display as below use the direction keys to navigate to the picture you wish to view and press the 'enter' button to view the image on screen. This will automatically go from picture to picture within the folder you can use the direction keys to rotate your picture on screen. At any time press the 'title' button to return to the root menu.

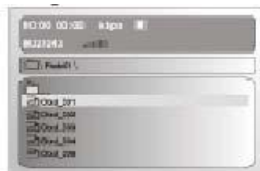

To enter your Setup Menu select 'setup' button to navigate through the menu use the direction keys and 'enter' to confirm your selection.

Language Setup

Language	English
	Spanish
	German
Subtitle	English
	Spanish
	German
	Auto
	Off
Divx Subtitle	Western European
	Central Europe
Audio	English
	Spanish
	German
DVD Menu	English
	Spanish
	German

Video

The audio menu gives you the following options

Aspect Ratio	Pan & Scan 16:9
	Letterbox 4:3
	Normal
View Mode	Fill
	Original
	Auto Fit
	Pan Scan

Setup Menu

TV System	NTSC
	PAL
	AUTO
Video Out	S-Video
	YUV
	RGB
	P-Scan
Smart Picture	Standard
	Vivid
	Cool
	Personal

Audio

In video menu you will have the following options

Digital Output	Off
	PCM
	RAW
Night Mode	On
	Off
Down Sampling	On
	Off

Rating

In Rating you will see the following options.

Parental Control	Settings
Set Password	Settings
	Settings (Supervisor Password : 0000)

Misc

In misc menu you will have the following options

Default	Reset
Screen Saver	Off
	On

If you are having any problems with your player, check below for a possible cause and solution.

Some simple checks or adjustment on your part may eliminate the problem and restore proper operation.

Symptom	Remedy
No Power	Insert the AC adaptor securely into the power outlet
No Picture	Ensure the equipment is connected properly
	Ensure you are in the correct mode on both the player and your TV
	Ensure the TV video socket is working properly
No Sound	Check the audio settings are correct
	Check the input setting for the TV and stereo system are correct
	Ensure the equipment is connected properly
The Disc Does Not Load	Ensure the disc has been inserted into the tray correctly (with label facing up)
	Make sure your disc is clean with no scratches
	Ensure the disc format is compatible
The Remote Does Not Respond	Check the batteries are in the correct polarity
	You are pointing the remote control at the sensor on the player and not your TV
My USB Is Not Loading	Ensure you are in USB mode
	Check the USB is connected securely
	Check files are compatible with the player

DVD Player

Power Supply	AC 90-240V - 50/60Hz
Power Consumption	11W
Weight	Around 1.5 Kg
Video System	NTSC/PAL/AUTO
Optical Read-Out System	Semiconductor ALGaAs Weam, Wave
Audio Frequency Response	DVD audio : Fs 48KHz PCM4 Hz~22KHz Fs 48KHz PCM4 Hz~22KHz
S/N Ration	290dB
Dynamic Range	290dB
Rotating Ration	Within measurable range
Operation Condition	Temperature 0°C-40°C

Output

Video Output	1.0V(p-p), 75 Ω
S-Video Output	(Y)1.0v(p-p), 75 Ω (C)0.286V(p-p), 75 Ω
Audio Output (Analog Audio)	2.0V(rms)



SLIMLINE DVD PLAYER

WARRANTY CARD

Congratulations! You have made an excellent choice with the purchase of this quality product. Our commitment to quality also includes our service. Should you, contrary to expectations, experience defeats due to manufacturing faults during private use within 36 months of the date of purchase we shall be liable for warranty in accordance with statutory warranty regulations provided that: -

- the device was not put to any use other than the intended
- was not overloaded
- was not used with the wrong accessories
- repairs were not carried out by any other than the authorised workshop

The warranty certificate is only valid in connection with the receipt. Please keep both in a safe place. This does not affect your statutory rights.

The purchase is guaranteed for a period of three years beginning on the day of purchase. Keep your purchase receipt safe as proof of date of purchase. The guarantee can only be extended for the duration of any repair required.

Should your item become defective during the warranty period, in the first instance, please call our customer service centre, they will then inform you of what to do next. We will at our discretion, either repair or exchange the device in accordance with warranty legislation.

Please enclose the following when sending your product in for repair: -

- 1.Receipt (proof of purchase)
- 2.This warranty certificate and fault report card complete with your contact details and fault description.

If the original receipt is not enclosed the repair will be charged in all cases. After the warranty has expired you can still send defective devices for repairs to the address stated below. Quotes as well as repairs after the warranty period are to be paid in all cases.

Ensure that the product is well packed as no responsibility can be accepted for items lost or damaged in transit. This warranty does not affect your statutory rights.





SLIMLINE DVD PLAYER

FAULT REPORT CARD

Name _____

Address _____

Email _____

Contact Tel No. _____

Model Number 44330

Fault Description _____

SERVICE HELPLINE

UK/N.Ireland 01270 508538

Rep.Ireland 1800 995 036

web: www.quesh.co.uk

Quesh Ltd
1 Solway Court
Crewe Business Park
Crewe, CW1 6LD