



WIRELESS POWERBANK



User Manual



PRODUCED IN CHINA FOR:
QESH LTD.
B7 FIRST BUSINESS PARK
FIRST AVENUE
CREWE, CHESHIRE
CW1 6BG
UNITED KINGDOM



AFTER SALES SUPPORT

18756

GB 01270508538
IE 1800 995 036

www.qesh.co.uk

MODEL: PBW-01 08/2019

Components

- 1 Wireless charging surface
- 2 Micro USB port
- 3 USB output
- 4 Wired charging indicator light
- 5 Wireless charging indicator light
- 6 Battery level indicator lights
- 7 On/Off button
- 8 Type C port
- 9 USB cable

General information

Reading and storing the user manual

This user manual accompanies this wireless power bank (hereafter referred to as the "product"), and contains important information on setup and handling.

Before using the product, read the user manual carefully. This particularly applies to the safety instructions. Failure to do so may result in personal injury or damage to the product.

The user manual is based on the standards and rules in force in the European Union. When abroad, you must also observe country-specific guidelines and laws.

Great care has gone into the manufacture of this product and it should therefore provide you with years of good service when used properly. In the event of product failure within its intended use over the course of the first 3 years after date of purchase, we will remedy the problem as quickly as possible once it has been brought to our attention. In the unlikely event of such an occurrence, or if you require any information about the product, please contact us via our helpline support services, details of which are to be found both in this manual and on the product itself.

Store the user manual for further use. Make sure to include this user manual when passing the product on to third parties.

Proper use

The product is exclusively designed for charging electronic devices, such as mobile phones, tablets or cameras. The wireless charging function can only be used with compatible mobile devices. It is only intended for private use and not suitable for commercial purposes. The product is not a children's toy.

Only use the product as described in this user manual. Any other use is considered improper and may result in damage to property or persons.

The manufacturer or vendor cannot be held liable for damages or injury incurred through improper or incorrect use.

Explanation of symbols

The following symbols and signal words are used in this user manual, on the product or on the packaging.

This symbol provides you with useful additional information on handling and use.

Declaration of Conformity (see chapter "Declaration of Conformity"): Products labelled with this symbol meet all applicable provisions of the European Economic Area.

Safety

Signal symbol/word definitions

WARNING!
This signal symbol/word designates a hazard with moderate risk, which may result in death or severe injury if not avoided.

NOTICE!

This signal word warns of possible damage to property.

Safety instructions

WARNING!

Risk of explosion!

Rechargeable batteries may explode if they are excessively heated up.

- Do not heat the product.
- Keep the product away from fire or other sources of heat.
- Protect the product from direct sunlight.
- Do not charge the product in the direct vicinity of hot surfaces or objects.

WARNING!

Risk of injury!

Improper handling of the product may result in injury.

- Do not operate the product if it exhibits visible damage or if the cable or connectors are defective.
- Do not allow children to play with the packaging wrapper. They may get caught in it when playing and suffocate.

NOTICE!

Risk of damage!

Improper handling of the product may result in damage to the product.

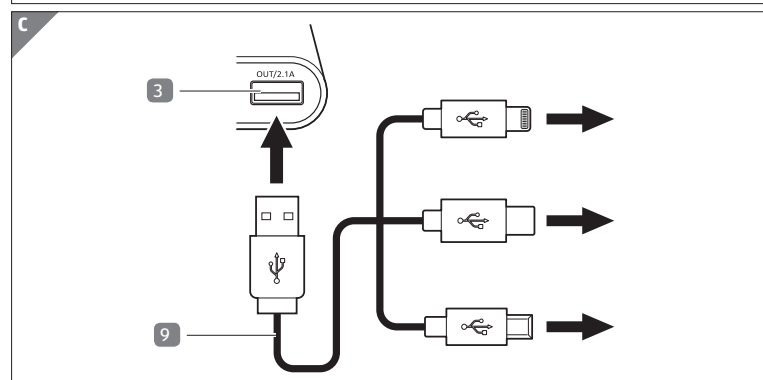
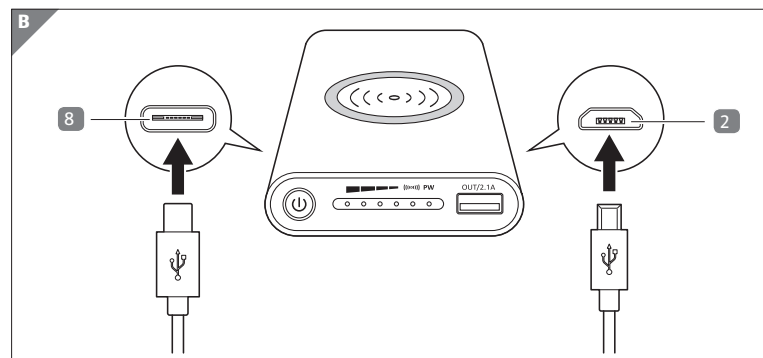
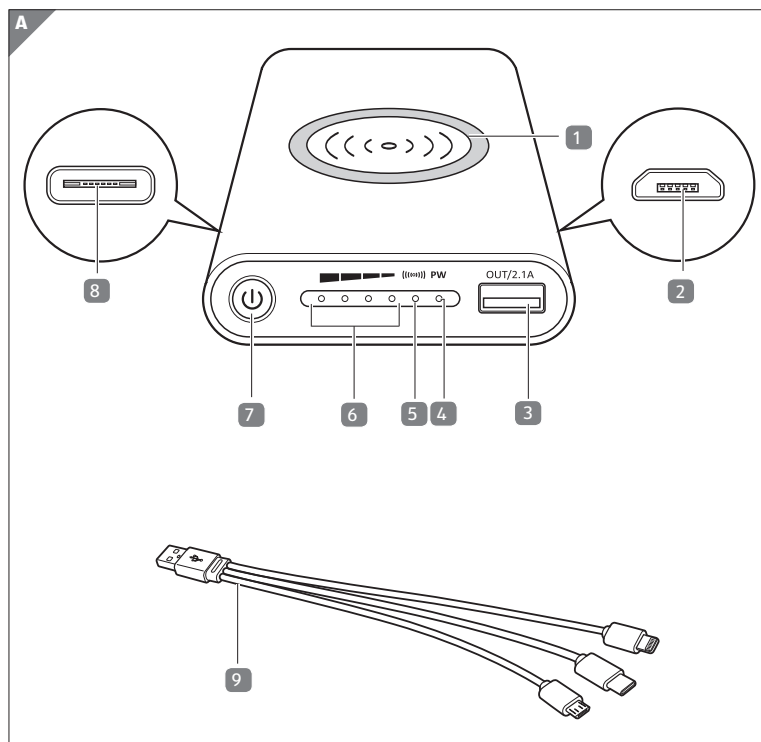

- Only parts that comply with the original device data may be used for repairs. Electrical and mechanical parts, which are essential for providing protection against sources of danger, are located in this product.
- Do not immerse the product or the USB cable in water or other liquids.
- Do not kink the USB cable and do not lay it over sharp edges.
- Only use the product in a well ventilated, dry and clean environment. Never operate the product in wet rooms or in the rain.
- Never store the product such that there is a risk of it falling in a tub or sink.

First use

Checking the product and package contents

NOTICE!

Risk of damage!

If you are not cautious when opening the packaging with a sharp knife or other pointed object, you may quickly damage the product.

- For this reason, be very careful when opening it.

1. Take the product out of the packaging.
2. Check to make sure that all parts are included (see **Fig. A**).
3. Check whether the product or individual parts are damaged. If this is the case, do not use the product. Contact the manufacturer via the service address indicated on the warranty card.

Charging the product

1. Connect the USB cable (9) to the Micro-USB port (2) or Type C port (8) of the product (see **Fig. B**).
2. Connect the other end of the USB cable to a USB power supply to start charging. Depending on the current battery level, the leftmost battery level indicator light (6) flashes during charging. When all battery level indicator lights come on solid blue, the charging is complete.
3. Disconnect the USB cable from the product and the USB power supply.

Switching the product on and off

To switch the product on, press the On/Off button (7). The two charging indicator lights (4) and (5) flash until the product is ready for use.

The product enters the wired charging mode by default and the wired charging indicator light comes on red.

To switch the product off, press the On/Off button twice. Alternatively, the product turns off automatically after approx. 30 seconds of idle time.

Checking the battery level

When the product is switched on, you can check the battery level by referring to the battery level indicator lights (6).

Battery level indicator light(s)	Battery level
1x	25 %
2x	50 %
3x	75 %
4x	100 %

Charging your device



Do not connect any device to the product for charging while the product itself is being charged.

Wireless charging

1. Switch the product on.
2. Put your compatible device to be charged on the centre of the wireless charging surface (1). The charging starts automatically with the wireless charging indicator light (5) flashes green slowly.

Wired charging

1. Connect the USB cable (9) to the USB output (3) (see **Fig. C**). The product is switched on.
2. Connect the corresponding connector of the USB cable (Micro USB/Type C/Lightning) to your device to be charged. The wired charging indicator light (4) comes on red.

Cleaning

NOTICE!

Risk of damage!

Improper handling of the product may damage it.

- Do not use any aggressive cleaners, brushes with metal or nylon bristles, or sharp or metallic cleaning utensils such as knives or hard scrapers. They could damage the surfaces.

1. Unplug the product before cleaning.
2. Use a damp cloth to wipe off the product. Then let all parts dry completely.

Storage

- Always store the product in a dry area.
- Protect the product from direct sunlight.

- Store the product so that it is not accessible to children.

Technical data

Model:	PBW-01
Built-in rechargeable battery:	10,000 mAh
Input:	DC 5 V/2.1 A
Output:	DC 5 V/1.0 A
Wireless receiving:	DC 5 V/750 mA
Frequency band:	105 kHz to 140 kHz

Maximum radio-frequency power transmitted:	5 W
Product code:	18756

Declaration of conformity



Hereby, Qesh Ltd declares that this power bank is in compliance with Directive 2014/53/EU. The full text of the EU declaration of conformity is available at the following internet address: www.qesh.co.uk

Disposal

Disposing of the packaging

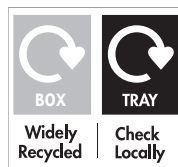

Sort the packaging before you dispose of it. Dispose of paper-board and card-board with the recycled paper

service and wrappings with the appropriate collection service.

Disposing of the product

(Applicable in the European Union and other European countries with separate collection systems of recyclable materials)

Old appliances may not be disposed of in the household waste!



Should the product no longer be capable of being used at some point in time, **dispose of it in accordance with the regulations in force in**

your city or county. This ensures that old appliances are recycled in a professional manner and also rules out negative consequences for the environment. For this reason, electrical equipment is marked with the symbol shown here.

Batteries and rechargeable batteries may not be disposed of with household waste!



As the end user you are required by law to bring all batteries and rechargeable batteries, regardless whether they contain harmful substances* or not, to a collection point run by the city or county, or to a retailer, so that they can be disposed of in an environmentally friendly manner.

Bring the entire product (including the rechargeable battery) to your collection point and make sure that the battery is in an uncharged state!

*labelled with: Cd = cadmium, Hg = mercury, Pb = lead